



# NEUTRAL PREMIUM BATTERIE RANGE



Version JANV 2017

## PRODUCT SHEET / FICHE TECHNIQUE

### Neutre Truck BCI Gr31 P105-1250

#### General



SAP #	616517 - 211318
EAN #	3663932014698
Technologie	Flooded/SLI
Alloy / Alliage	Ca / Ca
Maintenance	FREE
Origine	Europe
HS Code	85071020
Equivalent part	1250

#### Dimensions / Mass

Max Length (L)	330 mm
Max Width (W)	172 mm
Max Height (H)	240 mm
Mass (Weight)	23,7 Kg

#### Container

Group Size	GR31 (MF)
Case Material	Polypropylene
Color	Black / Black
Venting	Centralized
Cover	Labyrinth
Acid specific gravity	1,28
Bottom Hold Down	B01
Type of Terminal	Treaded Posts
Layout	9

#### Layout



#### Terminal Type

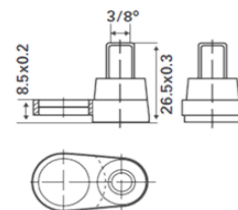

#### BASE Hold-Down

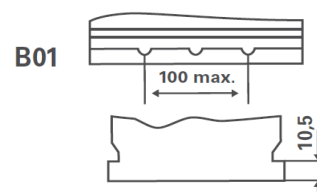

#### Electrical Spec.

Voltage	12 V
Capacity (20 hrs)	105 Ah
Reserve Capacity <small>indicative</small>	192 min
CCA (EN) @ -18°C	800 A
CCA (SAE) @ -18°C <small>indicative</small>	840 A
HCA @ 27°C <small>indicative</small>	1200 A

#### Transportation

Classified as :  
Batteries, wet, filled with Sulfuric Acid

UN number	UN 2794
Classification (ADR/RID)	Class 8
Packing Group (Not assigned for Land Transport)	III